

SUGGESTED CUSTOMER ENTRANCE.

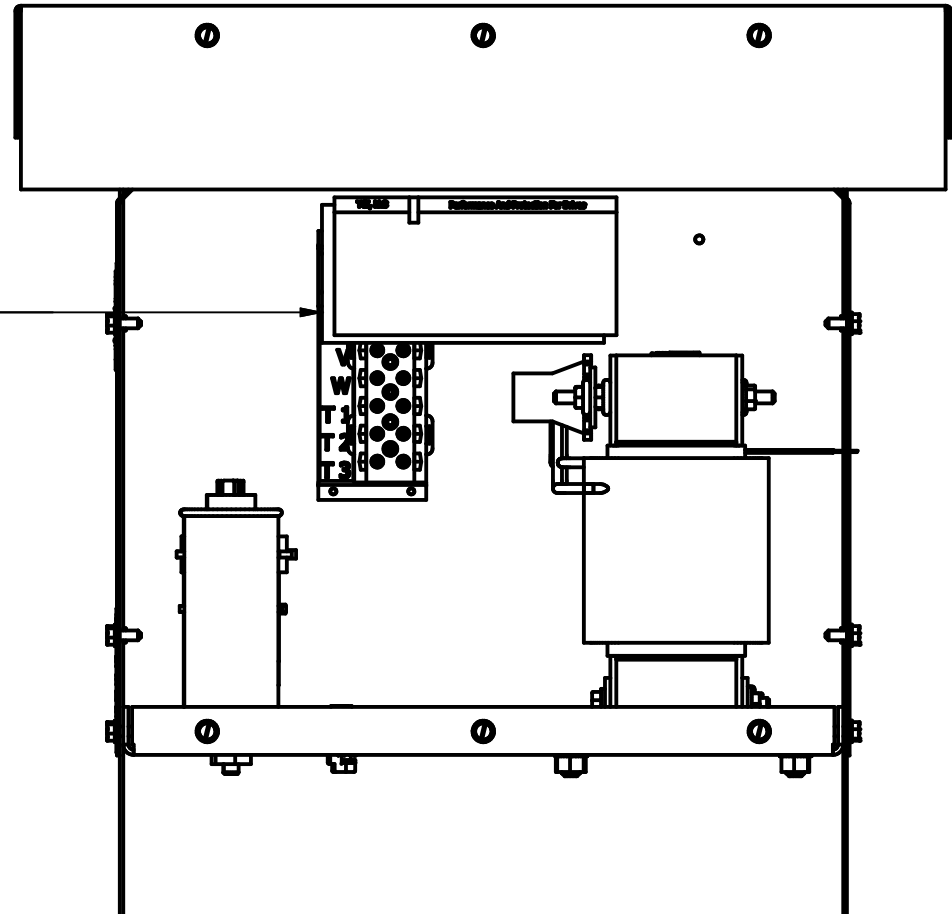
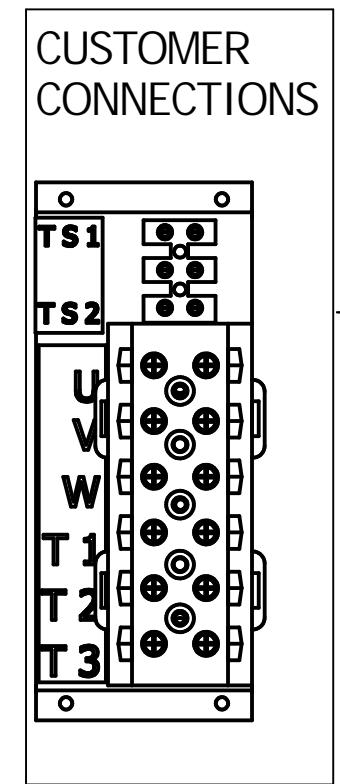

NOTE: FOR WIRE RANGE AND TORQUE INFORMATION SEE IOM MANUAL.

MSD PART NUMBER	HP	VOLTAGE	CURRENT	WEIGHT	TERMINAL BLOCK	GROUND LUG
MSD0022B300	7.5	240V	22 AMPS	90LBS	WIRE RANGE: 1-22AWG	WIRE RANGE: 1/0 -14AWG

CUSTOMER IS RESPONSIBLE FOR INSTALLATION TO MEET ALL NATIONAL AND LOCAL ELECTRICAL CODES.

NO	REVISION	DATE	BY	TOLERANCES (EXCEPT AS NOTED)	W132 N10611 Grant Drive Germantown, WI 53022
				DECIMAL .XX +/- .25 .XXX +/- .1	
C	3696 ADD DISCHARGE	8/1/16	DSW	FRACTIONAL +/- 1/16	<b>MSD0022B300</b> MotorShield Sinewave Filter 240/3/60, Type 1/ 3R.
B	3345 ENCLOSURE UPDATE	9/8/15	DSW	ANGULAR +/- 1°	
A	AS BUILT	8/10/15	BWM		DRN BY: BWM DATE: 8/10/15 SCALE: 1/4"
					DWG. No.: <b>106102DG</b> SHEET 1 OF 1